

SPECIFICATION

IARA

SUBMINIATURE POWER RELAY

CONTACT DATA (IARA)

| | | |
|----------------------------|-------------------------|-----------|
| Contact arrangement | 1A | 1C |
| Contact resistance | 100mΩ (at 1A 6VDC) | |
| Contact material | Silver alloy | |
| Contact rating (Res. load) | 20A 14VDC | 16A 14VDC |
| Minimum load | 100mA 6VDC | |
| Max. switching voltage | 16VDC | |
| Max. switching current | 20A | |
| Max. switching power | 280W | |
| Mechanical endurance | 1 x 10 ⁷ ops | |
| Electrical endurance | 1 x 10 ⁵ ops | |

CONTACT DATA

| | | |
|-------------------------------|-------------------------|--------------------------|
| Insulation resistance | | 100MΩ (at 500VDC) |
| Dielectric strength | Between coil & contacts | 1500VAC 1min |
| | Between open contacts | 500VAC 1min |
| Operate time (at nomi. Volt.) | | 15ms max. |
| Release time (at nomi. Volt.) | | 10ms max. |
| Shock resistance | Functional | 10G |
| | Destructive | 100G |
| Vibration resistance | | 10Hz to 55Hz 1.5mm |
| Humidity | | 40% to 85% RH |
| Ambient temperature | | -40°C to 85°C |
| Termination | | PCB |
| Unit weight | | Approx. 10g |
| Construction | | Wash tight, Flux proofed |

Notes : 1) The data shown above are initial values.

2) Please find coil temperature curve in the characteristic curves below.

COIL

| | |
|------------|---------------|
| Coil power | 640mW / 800mW |
|------------|---------------|

COIL DATA

at 23°C

(640mW)

| Nominal Voltage VDC | Pick-up Voltage VDC | Drop-out Voltage VDC | Rated Current (mA) | Coil Resistance Ω |
|---------------------|---------------------|----------------------|--------------------|-------------------|
| 9 | 5.85 | 0.45 | 71.4 | 126 x (1±10%) |
| 12 | 7.8 | 0.6 | 53.3 | 225 x (1±10%) |
| 24 | 15.6 | 1.2 | 26.7 | 900 x (1±10%) |

(800mW)

| Nominal Voltage VDC | Pick-up Voltage VDC | Drop-out Voltage VDC | Rated Current (mA) | Coil Resistance Ω |
|---------------------|---------------------|----------------------|--------------------|-------------------|
| 6 | 3.9 | 0.3 | 133.3 | 45 x (1±10%) |
| 12 | 7.8 | 0.6 | 66.6 | 180 x (1±10%) |
| 24 | 15.6 | 1.2 | 33.3 | 720 x (1±10%) |

ORDERING INFORMATION

| | | | | | |
|-------------------------------|--------------------------------|-----|-----|---|-----|
| | IARA | -1A | D12 | S | Nil |
| Type | | | | | |
| Contact form | 1A : 1 Form A 1C : 1 Form C | | | | |
| Coil voltage | 6, 9, 12, 24 VDC | | | | |
| Construction | S : Sealed type | | | | |
| Coil power (Only IRJ Type) | L : 0.64W Nil : 0.8W | | | | |

SAFETY APPROVAL RATINGS

| | | | |
|-------|----------------|-----------------|----------------|
| Model | Coiling rating | Safety Standard | Contact rating |
| IARA | 6 to 24VDC | CQC | 15A 14VDC |

Notes : 1) Only some typical rating are listed above. If more details are required, please contact us.

OUTLINE DIMENSIONS, WIRING DIAGRAM AND PC BOARD LAYOUT

Unit:mm

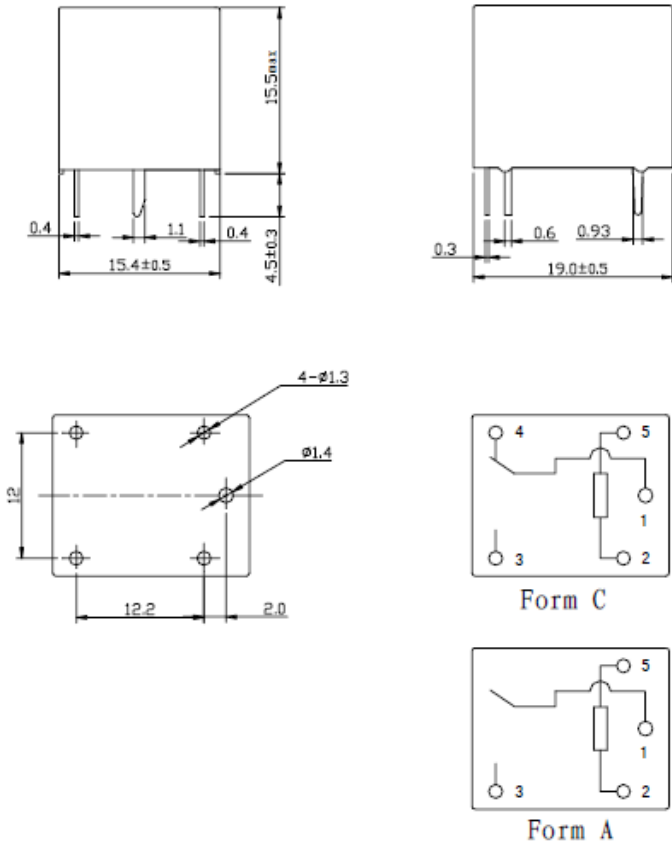

CHARACTERISTIC CURVES

